



Modern Urban Computer Shelf



Modern Urban Printer Shelf



Printer and Computer Shelf

## Modern Urban Desk Shelves

### Computer Shelves and Printer Shelves Add Storage

The Modern Urban Desk Shelves provide storage at your desk for computers, printers, UPS's, and any other device that you use at your desk. Shelves can be mounted on the inside or outside of the desk legs, which keeps them out of the way, yet always within reach, and close to the main desk cable tray and power strip. The shelf bracket attachment design makes shelves appear to float beside the desk leg or over the floor.

The 21" X 9" Modern Urban Computer Shelf is perfect for desktop computers and speakers. The 21" X 17.5" Modern Urban Printer Shelf is perfect for heavy printers and document centers.

There are two sizes of Modern Urban Desk Shelves, the Modern Urban Computer Shelf and Modern Urban Printer Shelf. Both have multiple mounting locations around the desk.

- Cherry Wood Shelves
- Sturdy Brackets
- Computer Storage
- Printer Storage

#### Versions:

##### Modern Urban Computer Shelf:

Part #: 511-0010-00-00-0

Size: H: 2.31" W: 9.00" D: 20.75"

Weight: 5 lbs.

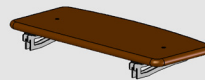

##### Modern Urban Printer Shelf:

Part #: 511-0011-00-00-0

Size: H: 3.26" W: 17.50" D: 20.75"

Weight: 10 lbs.

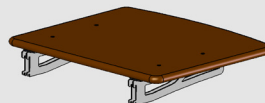
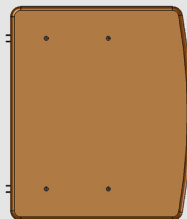

The way that the shelf bracket is attached to the desk leg makes the shelf appear to float over the floor.



635 Enterprise Drive  
Lewis Center, OH 43035  
Phone: 614-430-8660  
www.CarettaWorkspace.com  
Made in America

Questions? Call Us!  
(877)422-1088

## Modern Urban Desk Shelves: Features



### Wood Stain and Finish

The Modern Urban Desk Shelves are made of cherry board that is finished to match the color and texture of the Modern Urban Series Desks and other Caretta Workspace products. The wood on the shelves are finished on all sides. Each piece goes through a detailed 10-step finish process which is perfected with time and hand work.



### Laser-Cut Steel Bracket

The 12 gauge steel brackets that attach the shelves to the desk provide a good deal of support to hold heavy objects. The brackets are painted black to match the desk legs.



### Multiple Mounting Locations

There are many places to mount shelves on Modern Urban Series Desks. Each shelf has many attachment points on both the inside and outside of the desk legs.

## Modern Urban Desk Shelves: **Photos**



A Modern Urban 2 Desk with a **Computer Shelf** on the outside of the desk leg.



A Modern Urban 2 Desk with a **Computer Shelf** on the inside of the desk leg.

## Modern Urban Desk Shelves: **Photos (continued)**



There are many mounting positions for **Modern Urban Computer and Printer Shelves**.



635 Enterprise Drive  
Lewis Center, OH 43035  
Phone: 614-430-8660  
[www.CarettaWorkspace.com](http://www.CarettaWorkspace.com)  
Made in America

Questions? Call Us!  
(877) 422-1088

# Modern Urban Desk Shelves: Dimensions

## Modern Urban Computer Shelf:

Part #: 511-0010-00-00-0

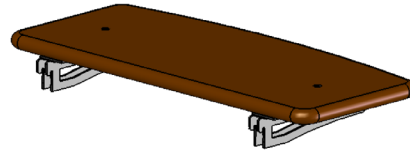
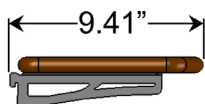
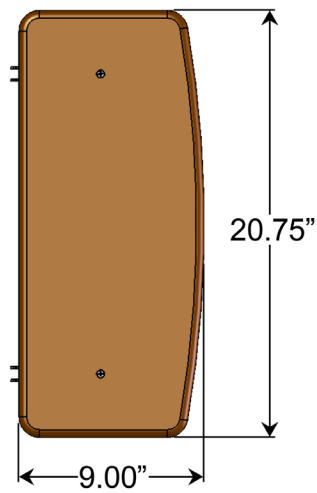

## Modern Urban Printer Shelf:

Part #: 511-0011-00-00-0

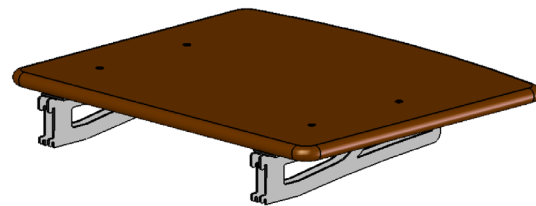
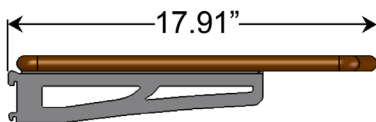
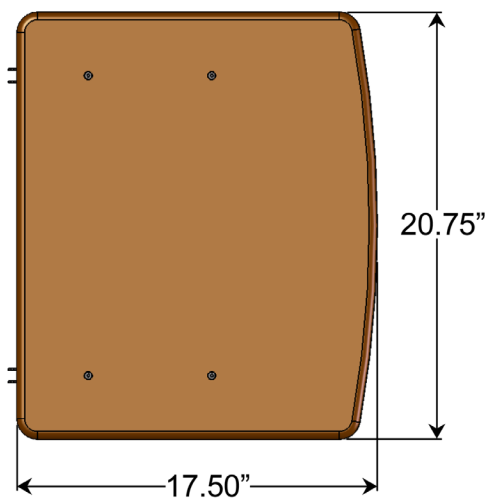

## Modern Urban Desk Shelves: **Specifications**

- Part Number:**
- Modern Urban Computer Shelf: 511-0010-00-00-0
  - Modern Urban Printer Shelf: 511-0011-00-00-0
- Compatible With:**
- Modern Urban Series Desks
- Dimensions:**
- Modern Urban Computer Shelf: H: 2.31" W: 9.00" D: 20.75"
  - Modern Urban Printer Shelf: H: 3.26" W: 17.50" D: 20.75"
- Weight:**
- Modern Urban Computer Shelf: 5 lbs.
  - Modern Urban Printer Shelf: 10 lbs.
- Wood Shelf:**
- 0.75" Thick with soft rounded edge
  - Premium cherry hardwood laminated board
- Wood Finish:**
- Natural cherry finish highlights wood grain
  - Hand-rubbed, 10-step finish process ensures quality
  - Meets or exceeds Standards of National Kitchen Cabinet Mfg. Association
  - Low VOC, formaldehyde free
  - Hand work in finish process ensures high quality
- Bracket:**
- 12 Gauge, laser-cut steel
  - Black textured paint
- Mounting Locations:**
- Can be mounted on the lowest position on the inside or outside of desk leg
  - There are multiple mounting locations on the desk
  - Shelves can be mounted on both sides of the desk leg at the same level

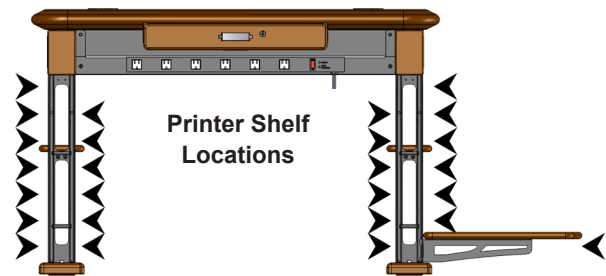
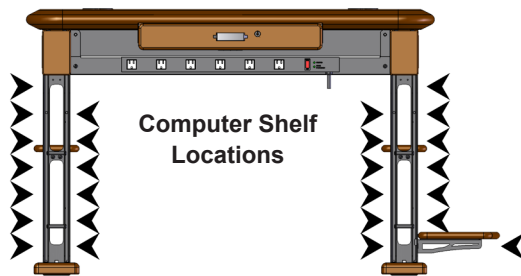

- Assembly:**
- Bracket attaches to leg by hooking into grooves in desk leg
  - Shelf attaches to bracket with two 10-32 screws
- Typical Lead Time:**
- 4 - 6 Weeks